

FOR TRI-TECH MODEL NUMBERS:

F4104 Nitrous Oxide

F4116 Medical Air

F4122 Medical Vacuum

F4124A Oxygen

OHMEDA (Ohio Medical) Diamond II or III Series Outlet

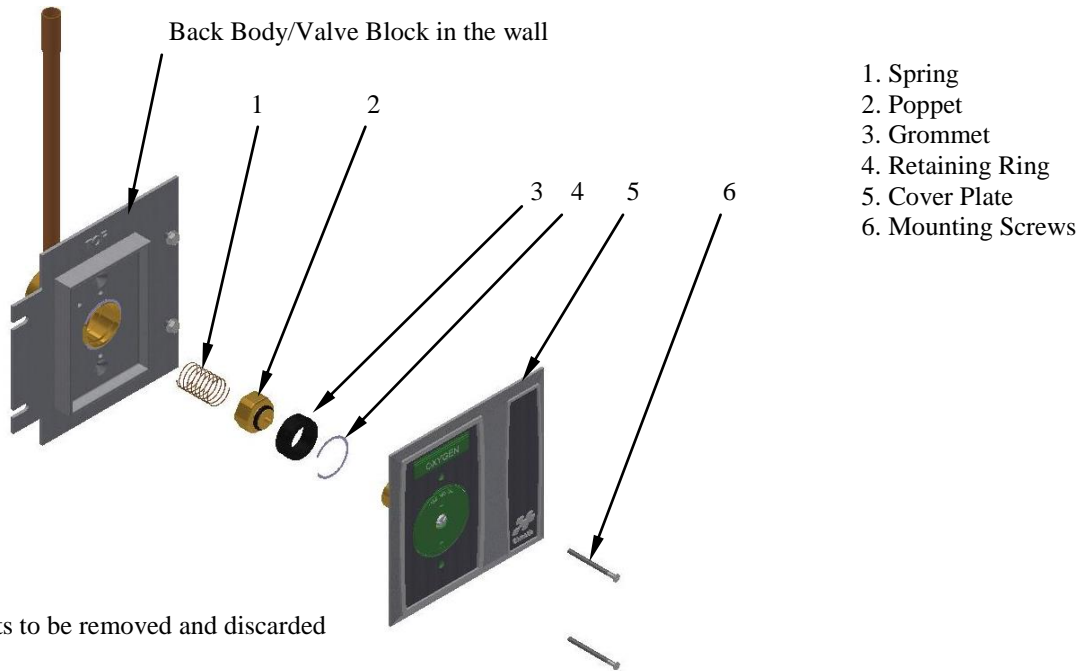
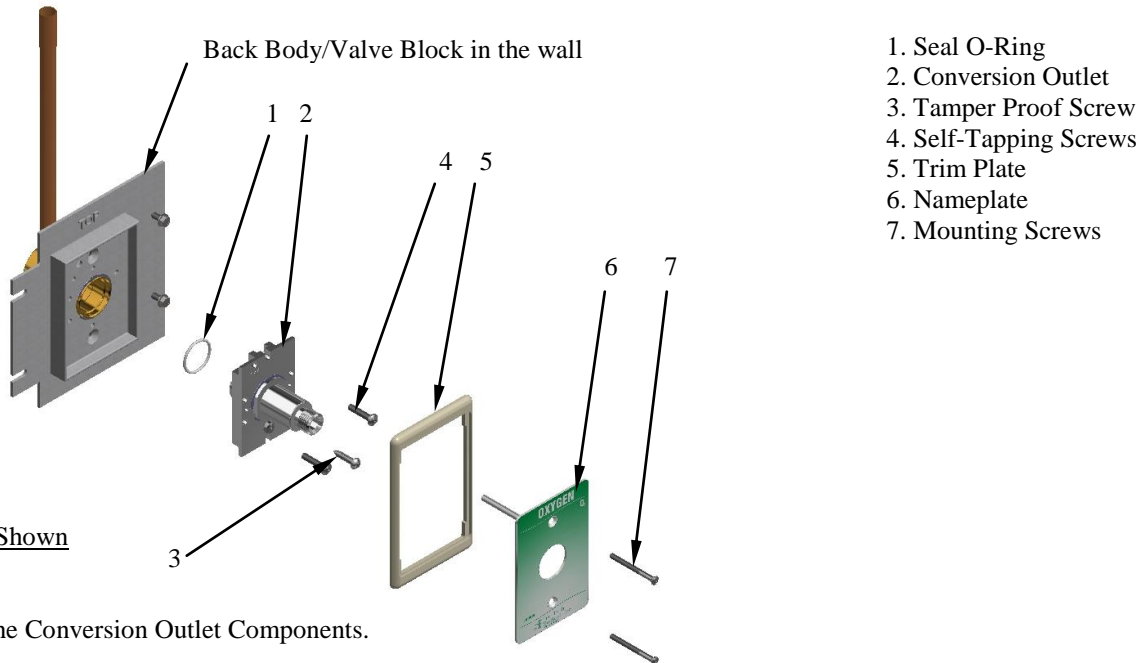

Figure 1
Outlet Components to be removed and discarded

Tri-Tech Conversion Outlet



Oxygen Outlet Shown

Figure 2
Installation of the Conversion Outlet Components.

Tools Needed

- 1- Phillips Screwdriver
- 1- Flat Blade Screwdriver

- 1- 3/16" Drill Bit
- 1- #29 Drill Bit

(Drill Bits provided with Drill Fixtures)

- Tri-Tech Drill Fixture Part No's.
- Nitrous Oxide F9904DF Vacuum F9922DF
- Medical Air F9916DF Oxygen F9924DF

Refer to reverse side for detailed instructions

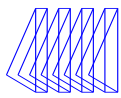

OHMEDA (Ohio Medical) Diamond II or III Series Outlet Disassembly

Close the area zone valve. Warning: Do not close zone valve until all personnel have been advised of the intended service and all systems requiring medical gas are being supplied from portable or alternate supplies. Bleed the residual gas pressure from the outlet.

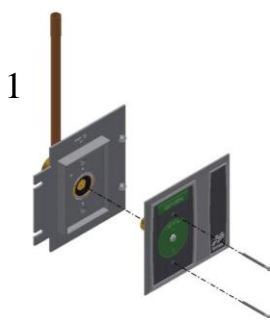

1
Loosen the mounting screws and remove the cover plate and outlet body assembly.

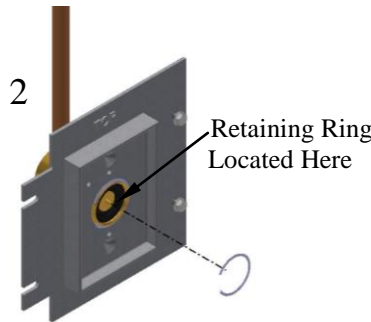

2
Using a flat blade screwdriver, pry off the internal retaining ring.

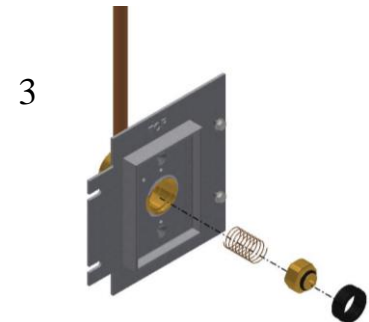

3
Remove sealing grommet, poppet, and spring.

Tri-Tech Conversion Outlet Installation Instructions

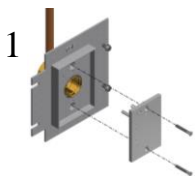

1
Install drill fixture plate. Tighten mounting screws alternately until snug. Indexing pin should engage existing indexing hole.

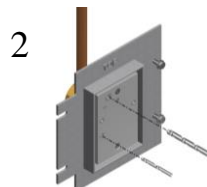

2
Drill one 3/16" dia. indexing hole and three #29 dia. holes through the appropriately marked drill bushings.

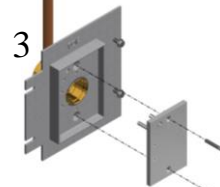

3
Remove drill fixture plate and clean all loose chips and debris from the outlet block.

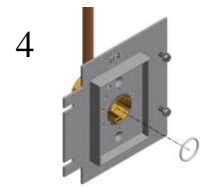

4
Slide Teflon® o-ring down internal diameter of existing outlet until it stops against the first shoulder.

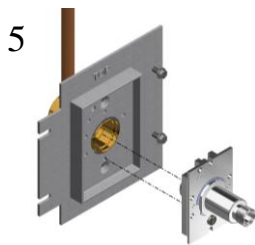

5
Insert conversion outlet into existing outlet through the Teflon® o-ring and push into place. Indexing pin should engage original indexing hole.

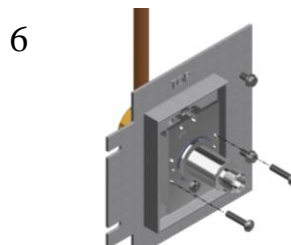

6
Start the two #8-32 self-tapping screws into the diagonally opposite holes as shown and alternately tighten each one turn until plate is drawn down snug.

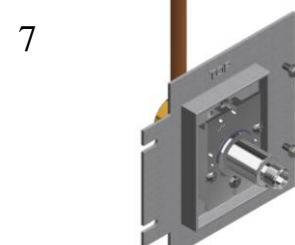

7
Test the outlet in accordance with NFPA Pamphlet 99.

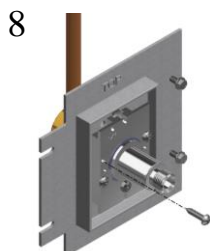

8
Install #8 tamper proof sheet metal screw as shown.

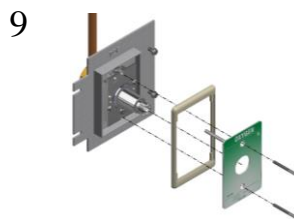

9
Align the trim plate and name plate so that the indexing pin slides through the indexing hole on the sub-mounting plate. Attach with mounting screws.

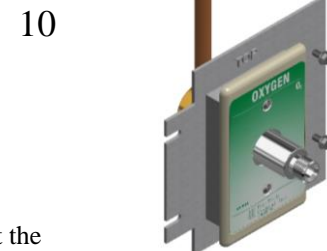

10
Conversion complete. Attach mating equipment