

FOR TRI-TECH MODEL NUMBERS:

F4004 Nitrous Oxide

F4016 Medical Air

F4022 Medical Vacuum

F4024A Oxygen

OHMEDA (Ohio Medical) Diamond I Series Outlet

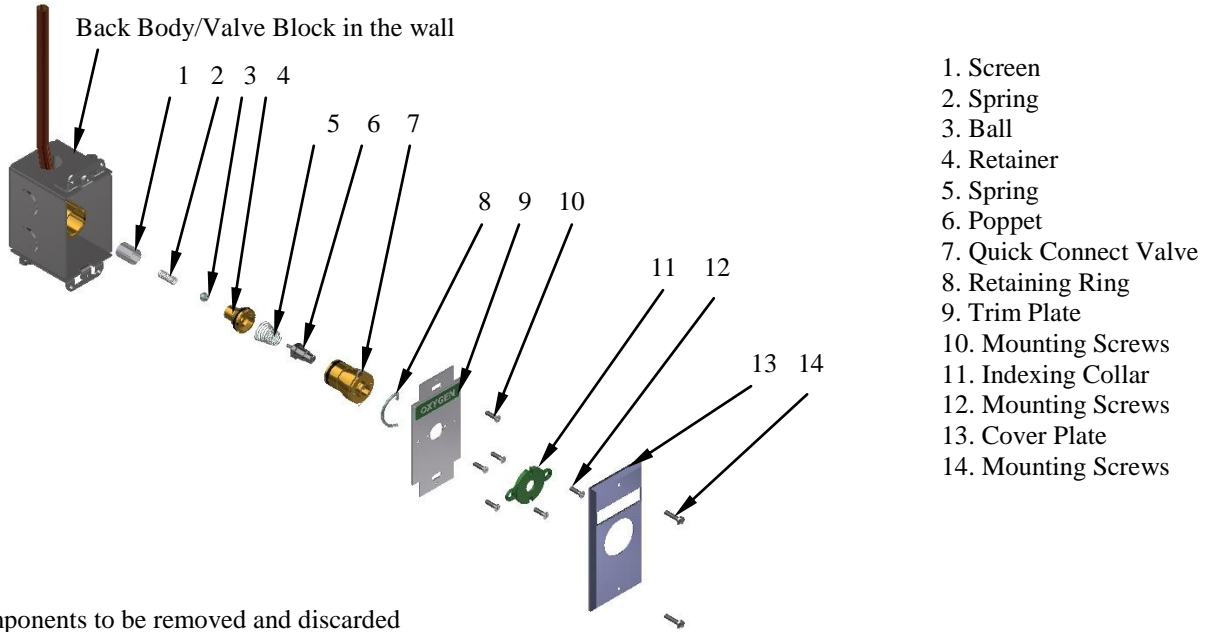
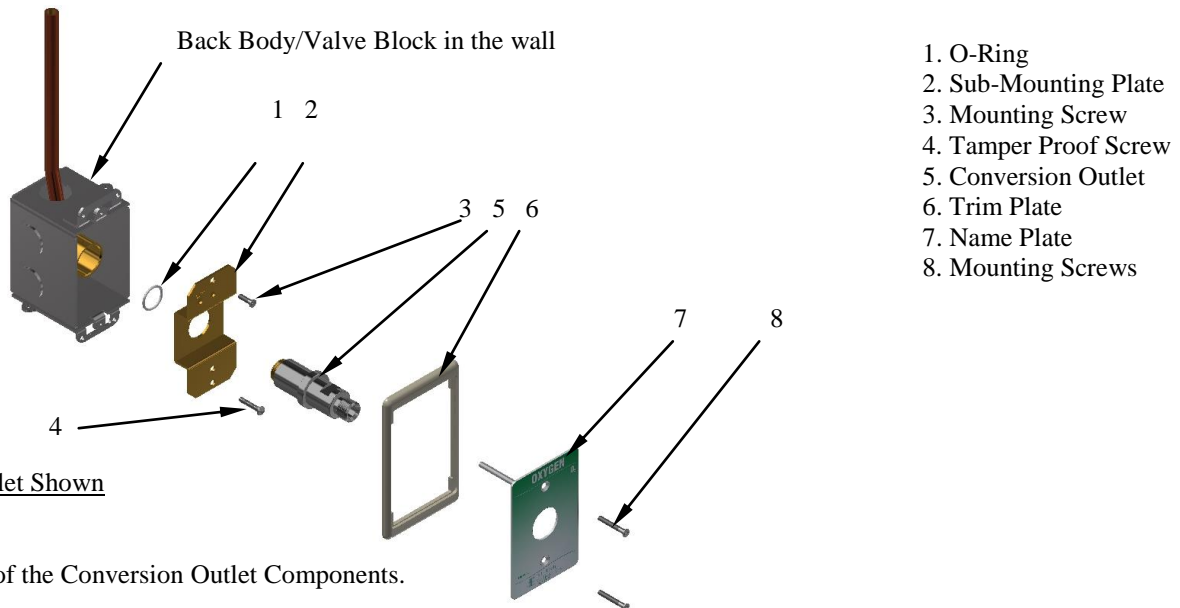

Figure 1
Outlet components to be removed and discarded

Tri-Tech Conversion Outlet



Oxygen Outlet Shown

Figure 2
Installation of the Conversion Outlet Components.

Tools Needed

1- Phillips Screwdriver
1- Flat Blade Screwdriver

1- 5/8" Hex Wrench
1- Loctite ® Adhesive
(Supplied w/Conversion Kit)

Retainer Removal Tool
Tri-Tech No. F9900TW

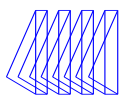

OHMEDA (Ohio Medical) Diamond I series Outlet Disassembly

Close the area zone valve. Warning: Do not close zone valve until all personnel have been advised of the intended service and all systems requiring medical gas are being supplied from portable or alternate supplies. Bleed the residual gas pressure from the outlet.

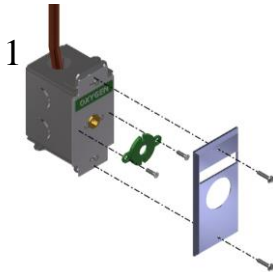

1 Remove the mounting screws that attach the cover plate and indexing collar.

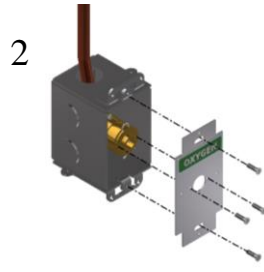

2 Remove the four (4) mounting screws holding the sub-mounting plate.

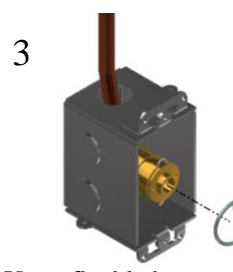

3 Use a flat blade screwdriver or another suitable tool to pry off the large retaining ring.

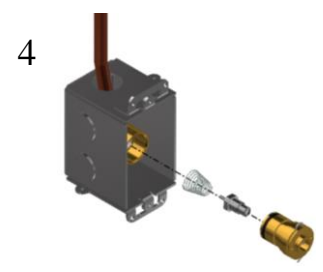

4 Remove the quick-connect and the spring and poppet.

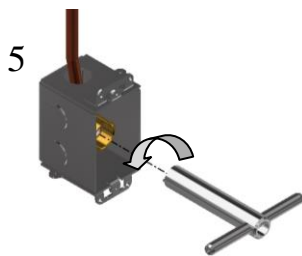

5 Using the retainer removal tool, align the prongs in the retainer groove and turn counter-clockwise to loosen the retainer.

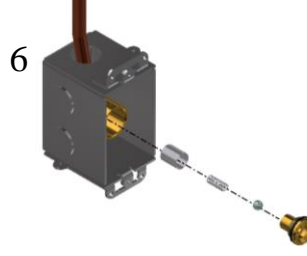

6 Remove the retainer, ball, spring, and screen filter.

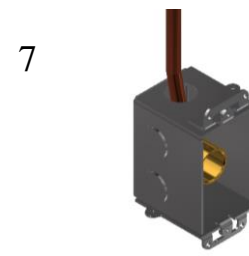

7 Clean all loose chips and debris from the outlet.

Tri-Tech Conversion Outlet Installation Instructions

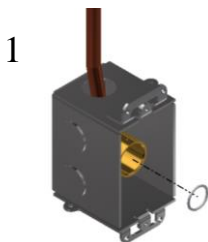

1 Insert Teflon O-ring so that it seats against the shoulder in the valve cavity.

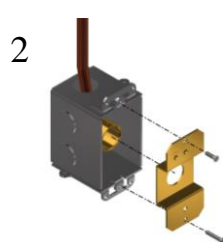

2 Position sub-mounting plate in box so that the gas name can be read from the front and assemble loosely with screws.



Apply Here

3 Apply Loctite® adhesive to male threads on outlet. Apply 4 drops approximately 90° apart, **DO NOT** apply to first thread.

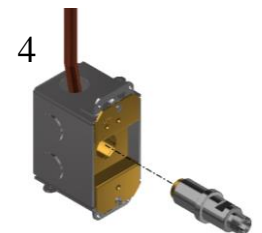

4 Insert conversion outlet through opening. Screw in handtight.

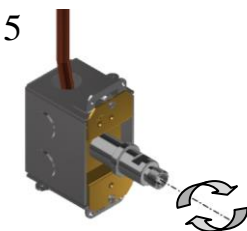

5 Using a 5/8" hex wrench, tighten outlet to secure washer and sub-mounting plate. (If outlet box is recessed below wall surface, it may be necessary to use a crows foot wrench.)

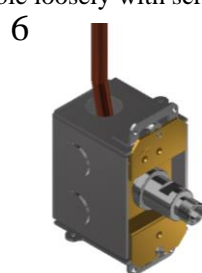

6 Tighten mounting screws and test in accordance with NFPA Pamphlet 99.

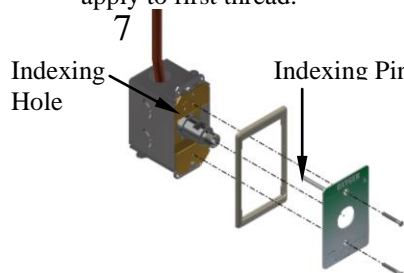

Indexing Hole

Indexing Pin

7 Align the trim plate and the name plate, so that the indexing pin slides through the indexing hole on the sub-mounting plate. Attach with mounting screws.



8 Conversion complete. Attach mating equipment.