

FOR TRI-TECH MODEL NUMBERS:

F4304 Nitrous Oxide F4316 Medical Air F4322 Medical Vacuum F4324A Oxygen

Schrader Outlet (1/4 NPT)

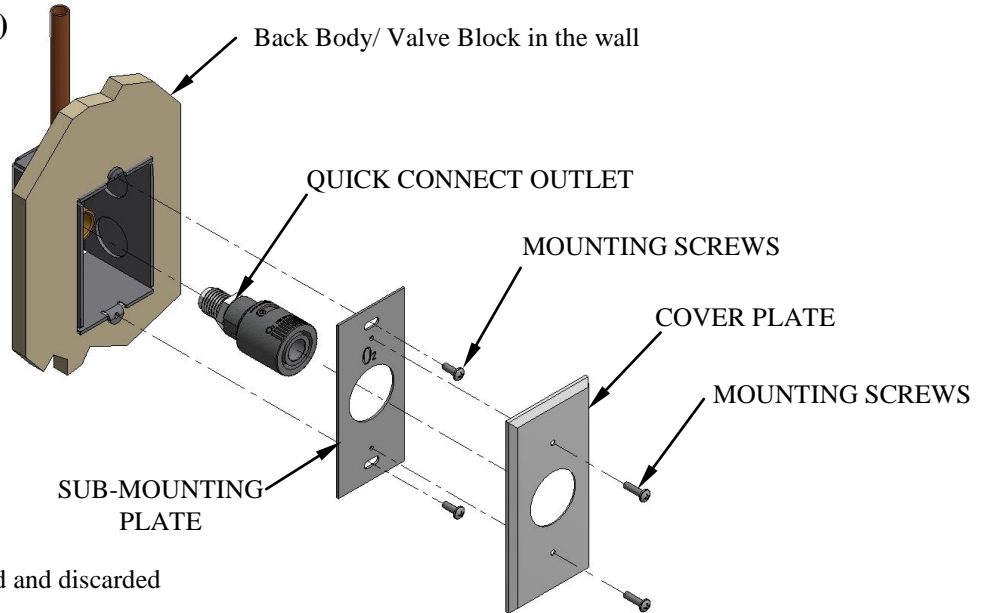
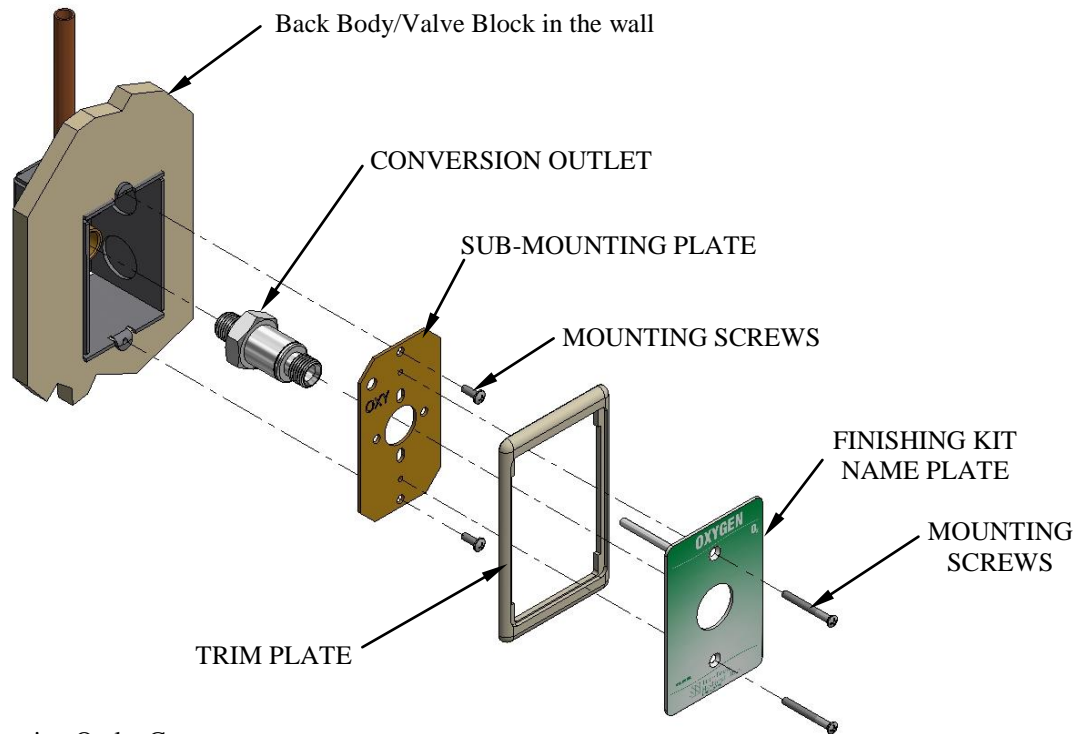

Figure 1
Outlet components to be removed and discarded

Tri-Tech Conversion Outlet



Oxygen Outlet Shown

Figure 2
Installation of the Conversion Outlet Components

Tools Needed: 1- Phillips Screwdriver 1-Flat Blade Screwdriver Loctite® (Supplied with Conversion Kit)
1" Hex Wrench 11/16" Hex Wrench

Refer to reverse side for detailed instructions

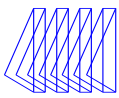

Schrader (1/4 NPT) Series Outlet Disassembly

Close the area zone valve. Warning: Do not close zone valve until all personnel have been advised of the intended service and all systems requiring medical gas are being supplied from portable or alternate supplies. Bleed the residual gas pressure from the outlet.

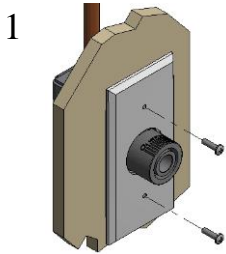

Remove mating equipment from the outlet. Using a screwdriver, unscrew the (2) the mounting screws.

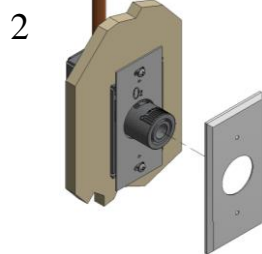

Remove cover plate.

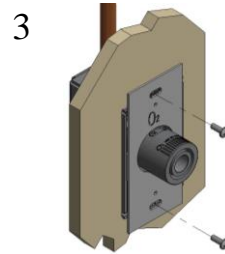

Using a Screwdriver, unscrew and remove the mounting plate

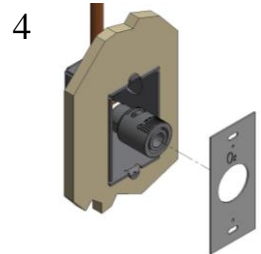

Remove the sub-mounting plate.

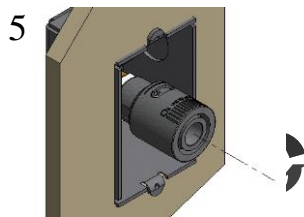

Use a 1 1/16" wrench, turn the outlet counter-clockwise.



Remove the outlet from the valve block.

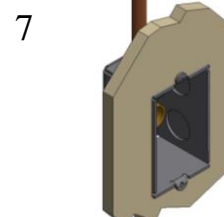

Clean all loose chips and debris from the valve block.

Tri-Tech Conversion Outlet Installation Instructions

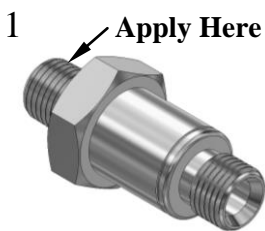

Apply Loctite® adhesive to the NPT threads in the outlet. Apply 4 drops approximately 90° apart. DO NOT apply to the first thread.

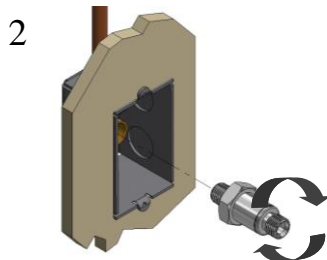

Insert the conversion outlet into the valve block cavity and turn the outlet clockwise to hand tighten.

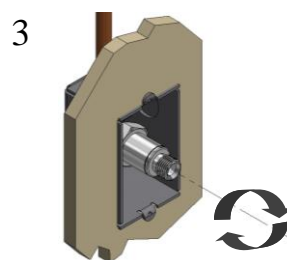

Use a 1" wrench to tighten the outlet in place.

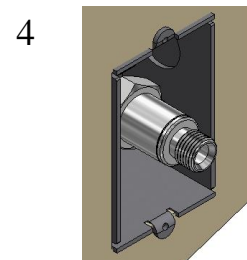

Test outlet in accordance with NFPA Pamphlet 99.

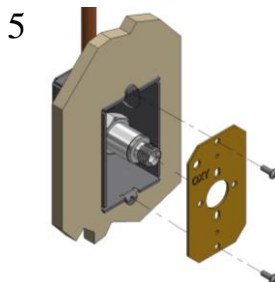

Align sub-mounting plate so that the gas name can be read from the front. Attach with mounting screws.

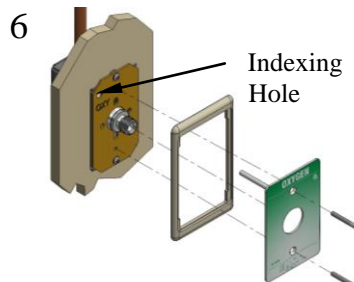

Align the cover plate so that the indexing pin slides through the indexing hole on the sub-mounting plate. Attach with mounting screws.



Conversion complete. Attach mating equipment.