

FOR TRI-TECH MODEL NUMBERS:

F3804 Nitrous Oxide

F3816 Medical Air

F3822 Medical Vacuum

F3824A Oxygen

**Chemetron/NCG 5/8" Outlet
248 Series**

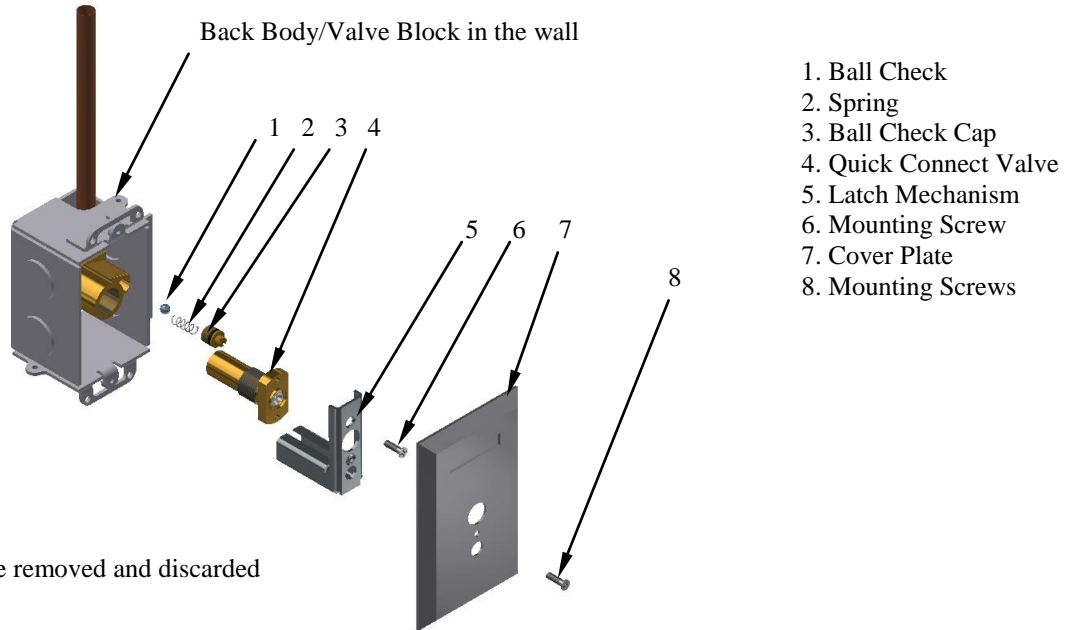

- 1. Ball Check
- 2. Spring
- 3. Ball Check Cap
- 4. Quick Connect Valve
- 5. Latch Mechanism
- 6. Mounting Screw
- 7. Cover Plate
- 8. Mounting Screws

Figure 1
Outlet components to be removed and discarded

Tri-Tech Conversion Outlet

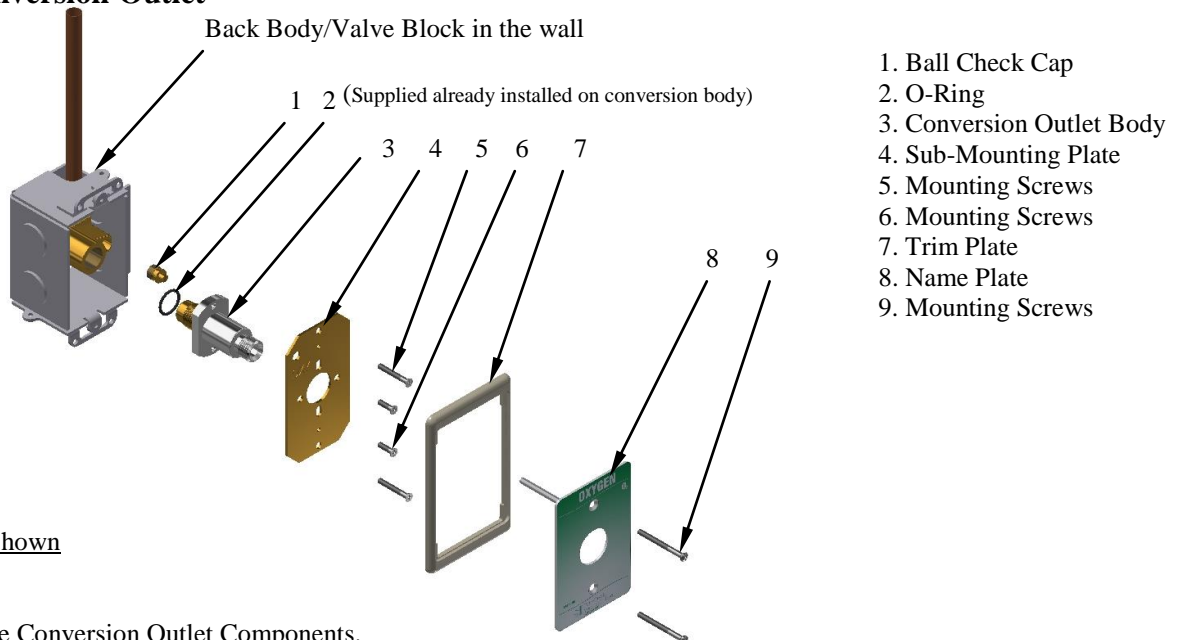

- 1. Ball Check Cap
- 2. O-Ring
- 3. Conversion Outlet Body
- 4. Sub-Mounting Plate
- 5. Mounting Screws
- 6. Mounting Screws
- 7. Trim Plate
- 8. Name Plate
- 9. Mounting Screws

Oxygen Outlet Shown

Figure 2
Installation of the Conversion Outlet Components.

Tools Needed

- 1- Phillips Screwdriver
- 1- Flat Blade Screwdriver

- 1- 7/8" or 1" Hex Wrench
- 1- 5/8" Hex Wrench

Loctite® Thread Sealer
(Supplied with Conversion Kit)

Refer to reverse side for detailed instructions

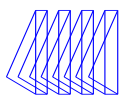

Chemetron / NCG 5/8" Outlet (248 Series) Disassembly

Close the area zone valve. Warning: Do not close zone valve until all personnel have been advised of the intended service and all systems requiring medical gas are being supplied from portable or alternate supplies. Bleed the residual gas pressure from the outlet.

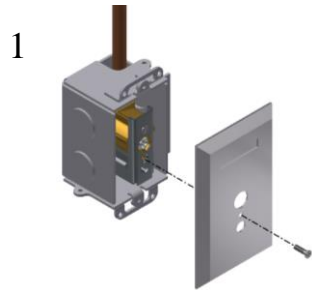

1 Remove the mounting screw and the cover plate.

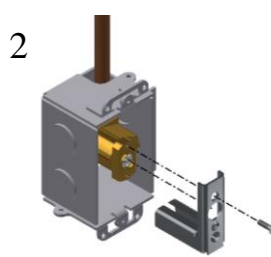

2 Remove the latch mechanism mounting screw and the latch mechanism.

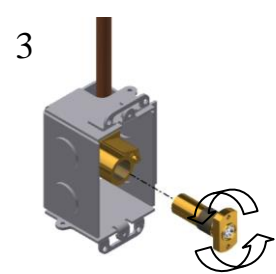

3 Using a 5/8" hex wrench, turn the quick-connect counter-clockwise to unscrew from the valve block.

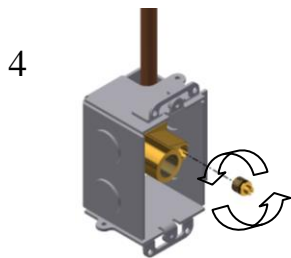

4 Unscrew the ball check cap (It may be necessary to use pliers to pull the cap free.)

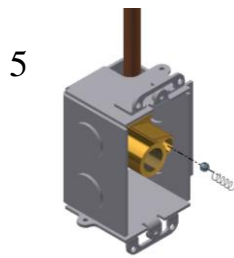

5 Remove and discard the spring and ball from the ball check cavity.

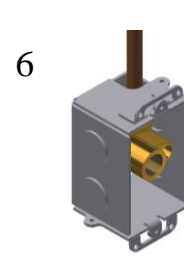

6 Test outlet in accordance with NFPA Pamphlet 99.

Tri-Tech Conversion Outlet Installation Instructions

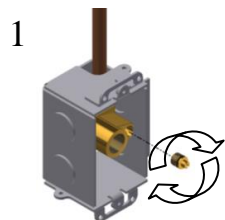

1 Install the supplied ball check cap.

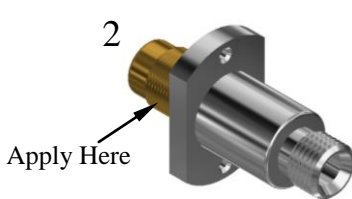

2 Apply Loctite® adhesive to male threads on outlet. Apply 4 drops approximately 90° apart **DO NOT** apply to first thread.

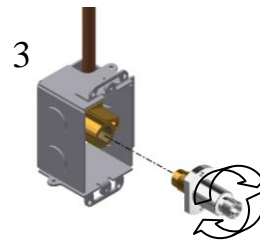

3 Position outlet against the valve block cavity and turn clockwise to screw outlet into the valve block.

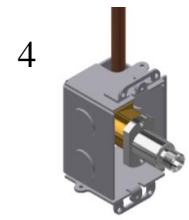

4 Use a 7/8" or 1" hex wrench, tighten outlet lining up the mounting screw holes vertically. **Do Not Over Tighten.**

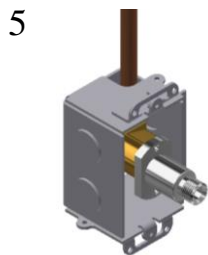

5 Test outlet in accordance with NFPA Pamphlet 99.

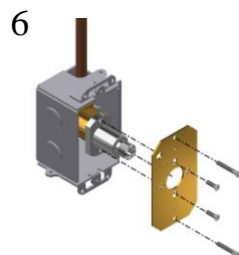

6 Align sub-mounting plate so that the gas name can be read from the front. Attach with mounting screws.

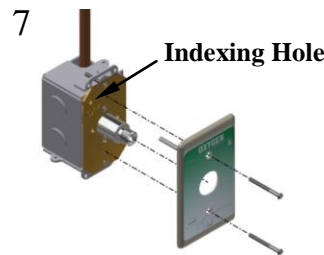

7 Align the trim plate and cover plate so that the indexing pin slides through the indexing hole on the sub-mounting plate. Attach with mounting screws.



8 Conversion complete. Attach mating equipment.