

FOR TRI-TECH MODEL NUMBERS:

F4604 Nitrous Oxide F4616 Medical Air F4622 Medical Vacuum F4624A Oxygen

Puritan "B" Series Outlet

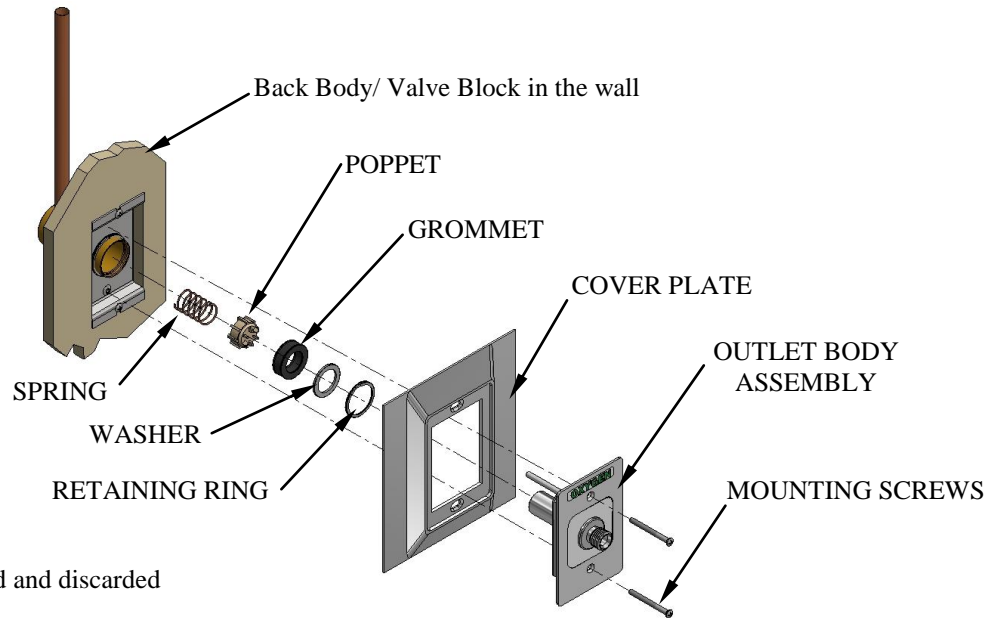
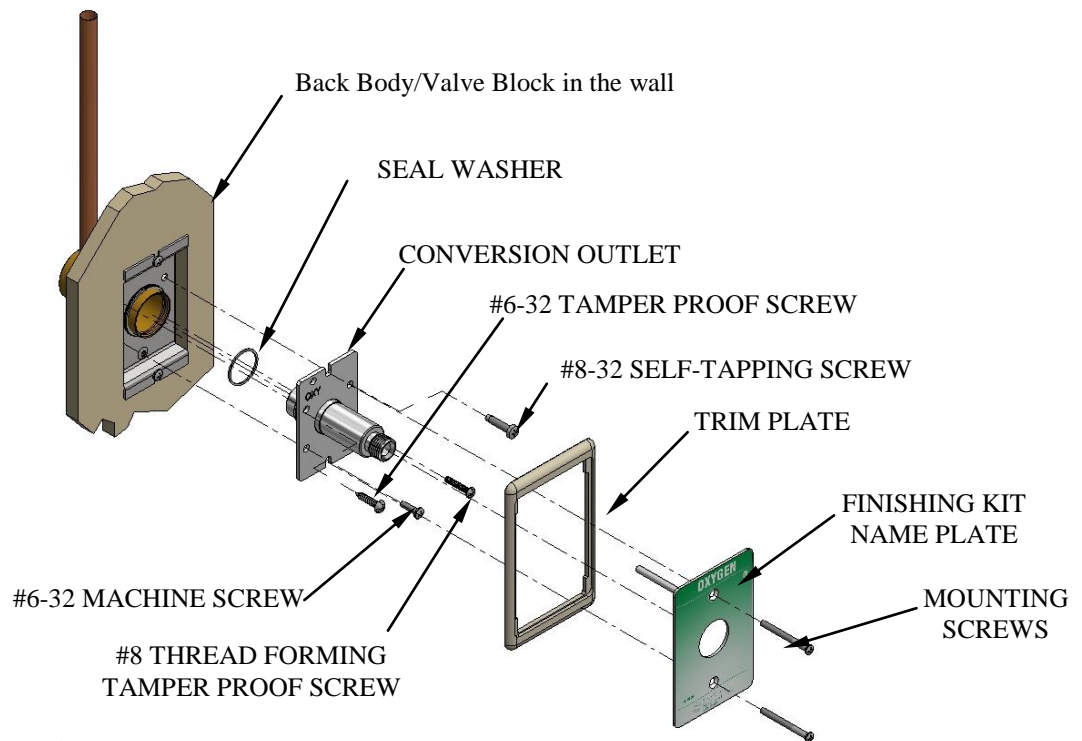

Figure 1
Outlet components to be removed and discarded

Tri-Tech Conversion Outlet



Oxygen Outlet Shown

Figure 2
Installation of the Conversion Outlet Components

Tools Needed: 1- Phillips Screwdriver 1-Flat Blade Screwdriver
*Tri-Tech Drill Fixture Part Number: F4604DF- Nitrous Oxide, F4616DF- Medical Air,
 F4622DF- Medical Vacuum F4624DF- Oxygen
 Supplied with fixture: 3/16" Drill Bit, & #29 Drill Bit*

Refer to reverse side for detailed instructions

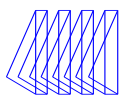

Puritan "B" Series Outlet Disassembly

Close the area zone valve. Warning: Do not close zone valve until all personnel have been advised of the intended service and all systems requiring medical gas are being supplied from portable or alternate supplies. Bleed the residual gas pressure from the outlet.

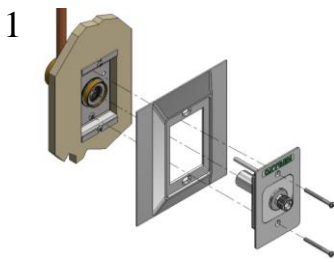

1 Remove mating equipment from the outlet. Loosen the mounting screws and remove the cover plate and outlet body assembly.

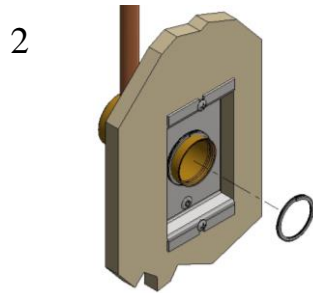

2 Using a flat blade screwdriver, pry off the internal retaining ring.

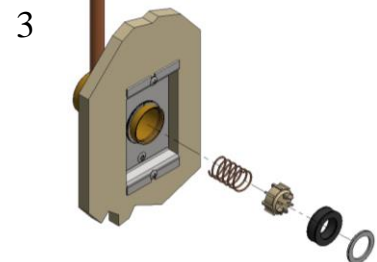

3 Remove washer, sealing grommet, poppet, and spring.

Tri-Tech Conversion Outlet Installation Instructions

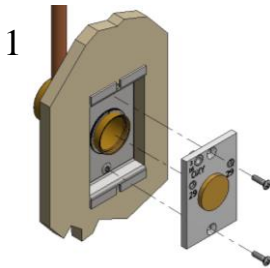

1 Install drill fixture plate. Tighten mounting screws alternately until snug. Text on plate should be upright.

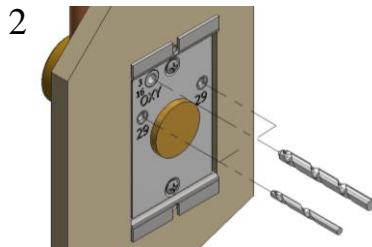

2 Drill one 3/16" dia. indexing hole and two #29 dia. holes through the appropriately marked drill bushings.

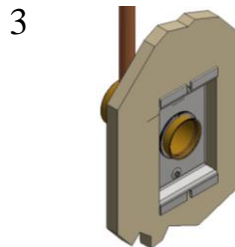

3 Remove drill fixture plate and clean all loose chips and debris from the valve block.

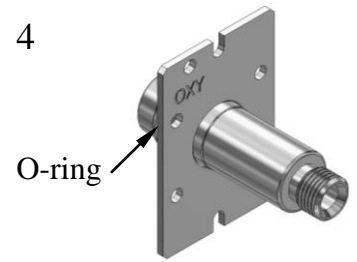

4 Lubricate O-ring on the conversion outlet. CAUTION: Use an oxygen compatible lubricant.

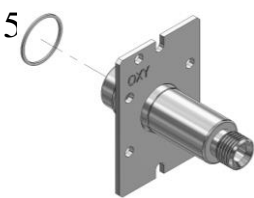

5 Slide Teflon® seal washer over the back diameter of the conversion outlet until it stops against the shoulder.

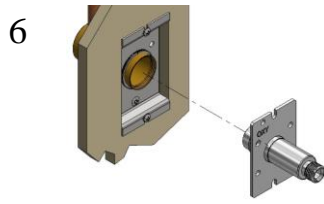

6 Insert conversion outlet into existing outlet and push into place.

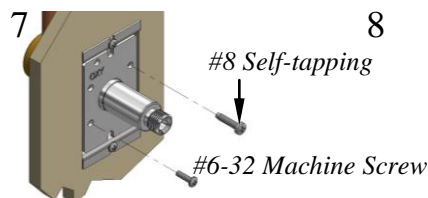

7 Start the #6-32 machine screw and the #8 self-tapping screw into the diagonally opposite holes as shown and alternately tighten each one turn until plate is drawn down snug.

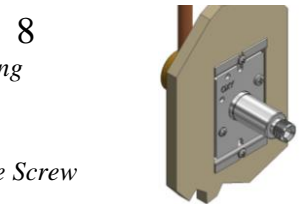

8 Test the outlet in accordance with NFPA Pamphlet 99.

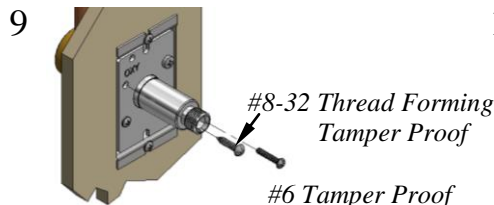

9 Install the #6-32 tamper-proof screw and the #8 thread forming tamper-proof screw as shown.

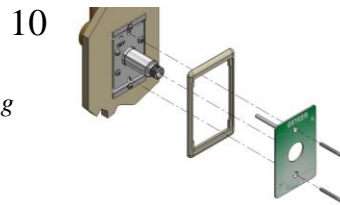

10 Position appropriate trim plate over the outlet and install the Frontall cover plate.

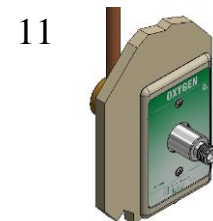

11 Conversion complete. Attach mating equipment.