

CONVERTING AN OHMEDA (Ohio Medical) DIAMOND I SERIES OUTLET

FOR TRI-TECH MODEL NUMBERS:

Q4004 Nitrous Oxide Q4016 Medical Air
Q4022 Medical Vacuum Q4024 Oxygen

OHMEDA (Ohio Medical) Diamond I Series Outlet

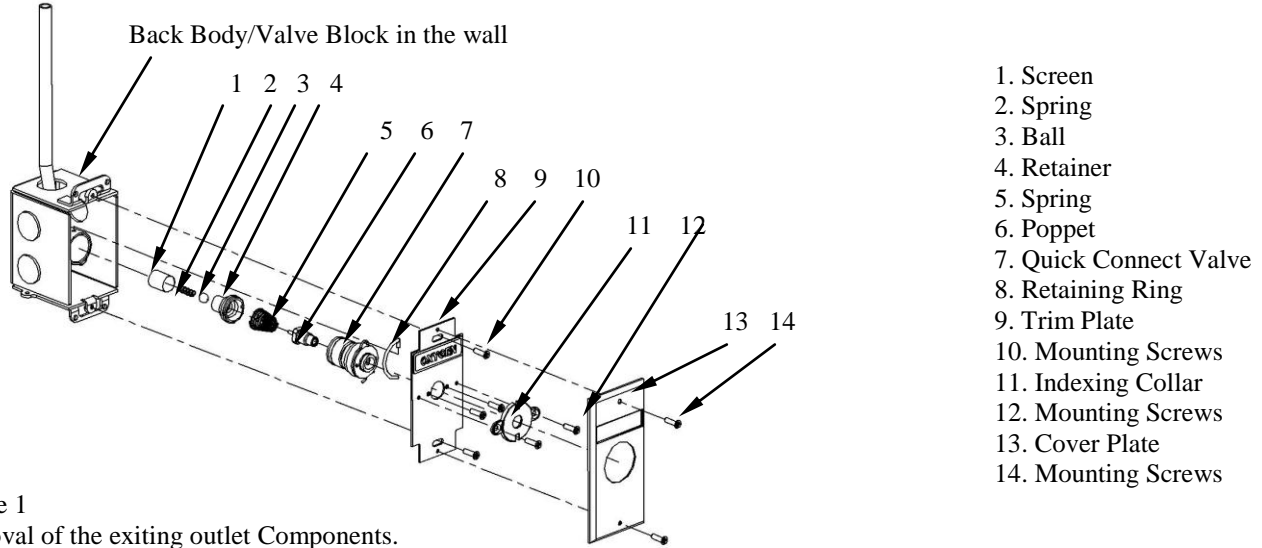
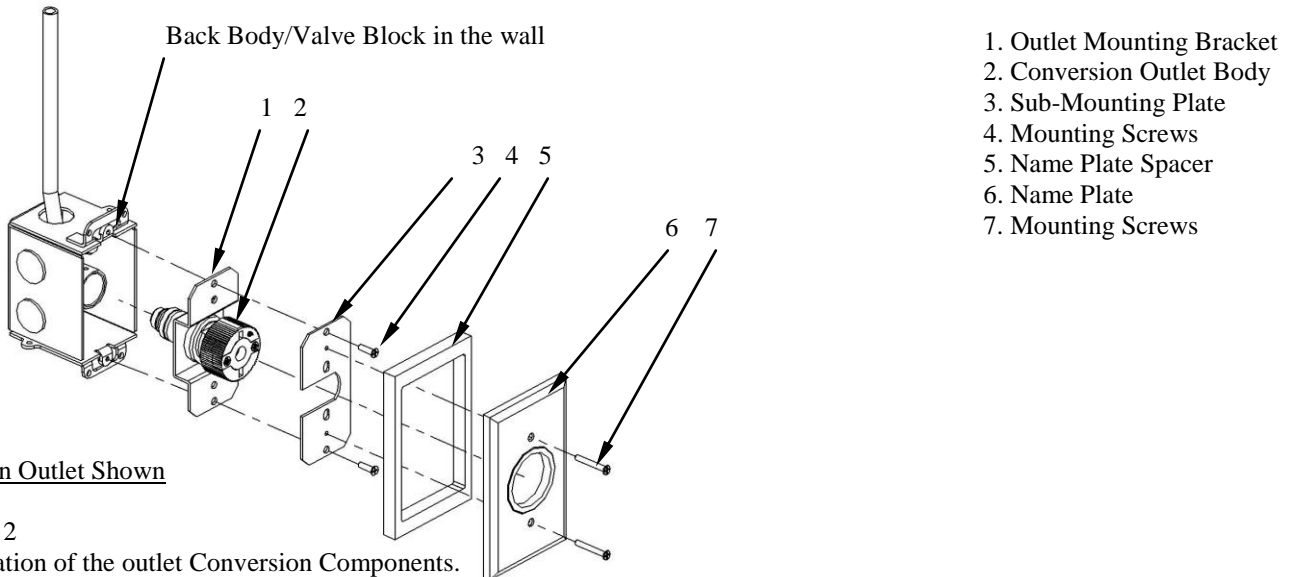

Figure 1
Removal of the exiting outlet Components.

Tri-Tech Conversion Outlet



Oxygen Outlet Shown

Figure 2
Installation of the outlet Conversion Components.

Tools Needed

1- Phillips Screwdriver	Retainer Removal Tool
1- Flat Blade Screwdriver	Tri-Tech No. F9900TW

Refer to reverse side for detailed instructions

OHMEDA (Ohio Medical) Diamond I series Outlet Disassembly

Close the area zone valve. Warning: Do not close zone valve until all personnel have been advised of the intended service and all systems requiring medical gas are being supplied from portable or alternate supplies. Bleed the residual gas pressure from the outlet.

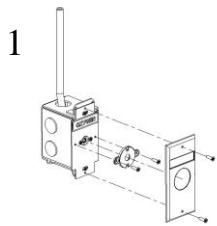

1 Remove the mounting screws that attach the cover plate and indexing collar.

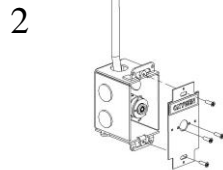

2 Remove the four (4) mounting screws holding the sub-mounting plate.

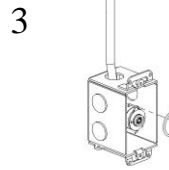

3 Use a flat blade screwdriver or another suitable tool to pry off the large retaining ring.



4 Remove the quick-connect and the spring and poppet.

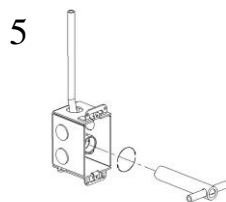

5 Using the retainer removal tool, align the prongs in the retainer grooves and turn counter-clockwise to loosen the retainer.

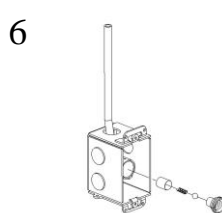

6 Remove the retainer, ball, spring, and screen filter.

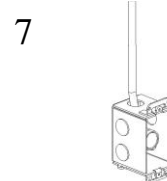

7 Clean all loose chips and debris from the outlet.

Tri-Tech Conversion Outlet Installation Instructions

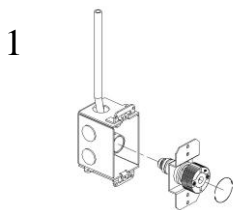

1 Place conversion body with loose bracket in valve cavity. Position "U" shaped sub-mounting bracket in the back box and loosely assemble with two (2) short screws.

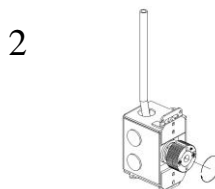

2 Screw the outlet body into the valve cavity clockwise with moderate pressure until resistance is felt from the large o-ring against the bracket. Continue hand tightening conversion outlet body until gas name is horizontal and arrow is pointing up.

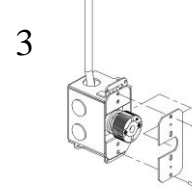

3 Remove the two (2) short screws holding the sub-mounting bracket in place. Slide the notched sub-mounting plate over the mill flats of the outlet body until it lines up with the sub-mounting bracket.

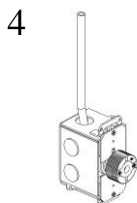

4 Using the two (2) short screws, secure the notched sub-mounting plate and sub-mounting bracket to the back box and test in accordance with NFPA Pamphlet 99.

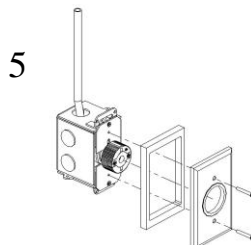

5 Position the flat trim plate (normally used only with ganged outlets), name plate assembly and spacer over the conversion outlet and secure with mounting screws.

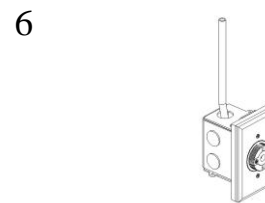

6 Conversion complete.