

CONVERTING AN AMICO RECESSED WALL OUTLET

FOR TRI-TECH MODEL NUMBERS:

F4704 Nitrous Oxide F4716 Medical Air
F4722 Medical Vacuum F4724A Oxygen

Amico Outlet

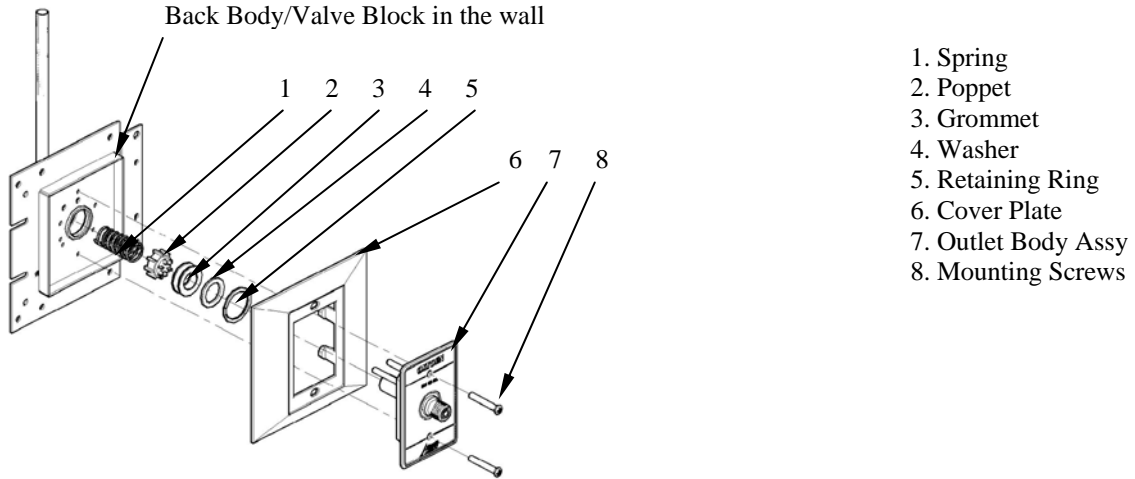

1. Spring
2. Poppet
3. Grommet
4. Washer
5. Retaining Ring
6. Cover Plate
7. Outlet Body Assy
8. Mounting Screws

Figure 1
Removal of the exiting outlet Components.

Tri-Tech Conversion Outlet

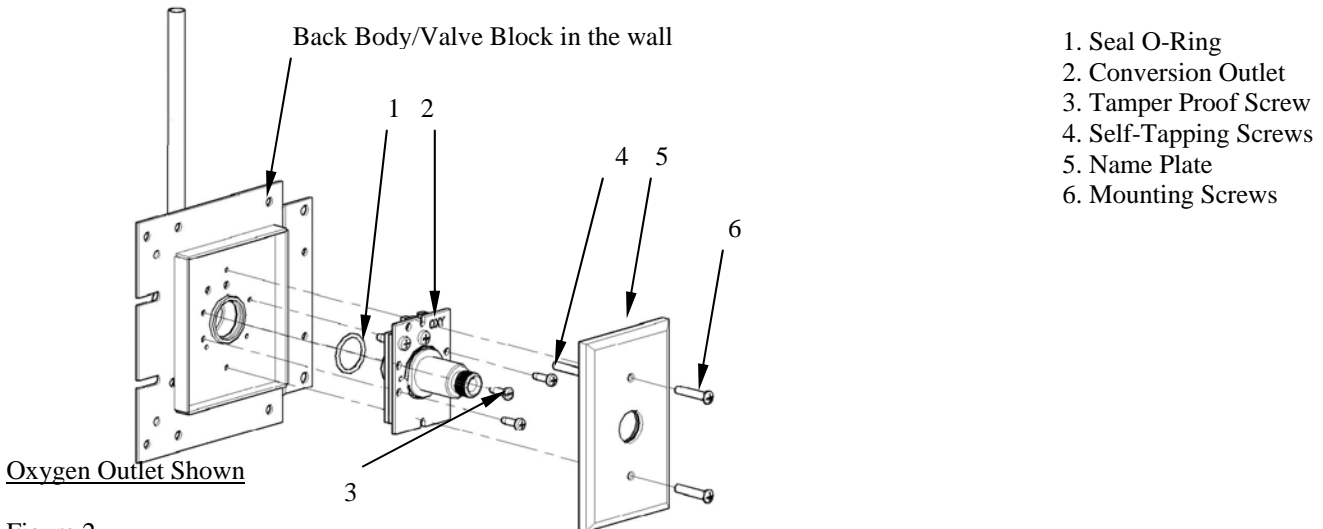

1. Seal O-Ring
2. Conversion Outlet
3. Tamper Proof Screw
4. Self-Tapping Screws
5. Name Plate
6. Mounting Screws

Figure 2
Installation of the outlet Conversion Components.

Tools Needed

1- Phillips Screwdriver	1- 3/16" Drill Bit	Tri-Tech Drill Fixture Part No's.
1- Flat Blade Screwdriver	1- #29 Drill Bit	Nitrous Oxide F4704DF Vacuum F4722DF
		Medical Air F4716DF Oxygen F4724DF

Refer to reverse side for detailed instructions

Amico Outlet Disassembly

Close the area zone valve. Warning: Do not close zone valve until all personnel have been advised of the intended service and all systems requiring medical gas are being supplied from portable or alternate supplies. Bleed the residual gas pressure from the outlet.

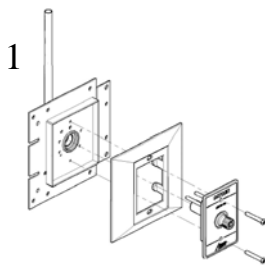

Loosen the mounting screws and remove the cover plate and outlet body assembly.

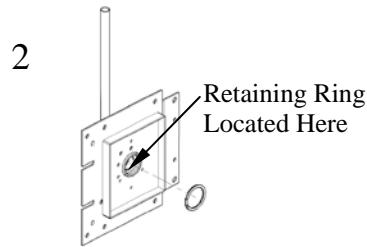

Using a flat blade screwdriver, pry off the internal retaining ring.

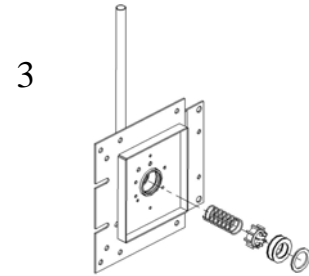

Remove washer, sealing grommet, poppet, and spring.

Tri-Tech Conversion Outlet Installation Instructions

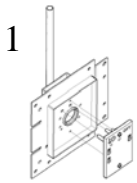

Install drill fixture plate. Tighten mounting screws alternately until snug. Indexing pins should engage existing indexing holes.

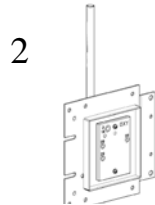

Drill one 3/16" dia. indexing hole and three #29 dia. holes through the appropriately marked drill bushings.

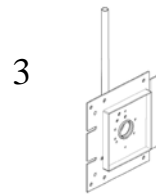

Remove drill fixture plate and clean all loose chips and debris from the outlet block.

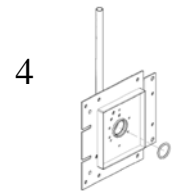

Slide Teflon® o-ring down internal diameter of existing outlet until it stops against the first shoulder.

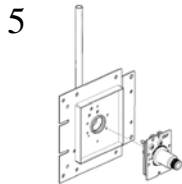

Insert conversion outlet into existing outlet through the Teflon® o-ring and push into place. Indexing screws should engage original indexing holes.

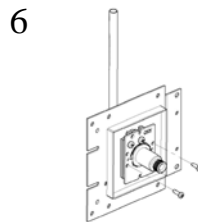

Start the two # 8-32 self-tapping screws into the diagonally opposite holes as shown and alternately tighten each one turn until plate is drawn down snug.

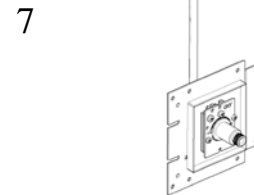

Test the outlet in accordance with NFPA Pamphlet 99.

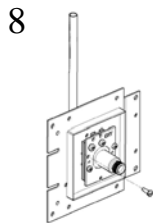

Install #8 self-tapping tamper proof sheet metal screw as shown.

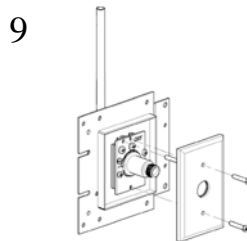

Position name plate over outlet so that the indexing pin slides through the indexing hole on the sub-mounting plate. Attach with mounting screws.

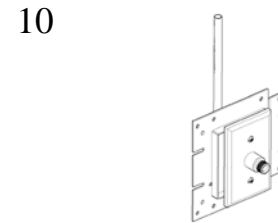

Conversion complete. Attach mating equipment